



CRANHAM
SCOUT CENTRE

Welcome Pack

Cranham Scout Centre

at the heart of Scouting in Gloucestershire

“We’re Proud & You’re Welcome”

Thank you for booking your visit to Cranham Scout Centre.

This booklet is designed to provide information about the centre; its facilities, activities, rules and procedures, and can be used to assist with your programme planning. We hope that there is sufficient information here, but further details can be found on our website (www.scoutcentre.org.uk) or by contacting the office on the details below.

Please ensure that you read this booklet before you visit and pass on any relevant information to all members of your group.

All the staff and volunteers at Cranham hope that you thoroughly enjoy your stay, and if you have any requests or queries while you are here, we are always happy to assist you.

Cranham Scout Centre

Cranham, Gloucestershire, GL4 8HP

Telephone: 01452 812309

Email: info@scoutcentre.org.uk



Contents

Site Information, Arrivals, Departures and Payment.....	Page 3
On Site Activities	Page 4
Off Site Activities.....	Page 5
Places to Visit	Page 6
Emergency Procedures, Hospitals and Doctors	Page 7
Safeguarding and Risk Assessments	Page 8
Directions.....	Page 9
Site Plan – Main Site.	Page 10
Site Plan – Daniels’ Grove.	Page 11
Camping & Activities - Site Care & Services (<i>Rubbish, Recycling, Water, Fires,, etc</i>).....	Page 12
Accommodation - Main Centre.....	Page 13
Departures	Page 14
Kitchen Inventory.....	Page 15
Accommodation - Cabins	Page 16
Departures	Page 16
Day Cabin Kitchen Inventory	Page 17



Site Information

Cranham Scout Centre is situated in a lovely Cotswold valley on the edge of the village of Cranham, Gloucestershire. It comprises a main camping area, a residential centre with accommodation and on site activities. There is also a wooded valley, called Daniel's Grove, where there are smaller camping areas and further activities. The Scout Centre is adjacent to over 1200 acres of beech woodland to which we have access for activities such as nature trails and orienteering. It is also a good source of firewood.

The Centre is open to Scouts, Guides, schools and other youth groups and training and corporate organisations and businesses. The centre is also used as a base for those on Duke of Edinburgh Award expeditions and training courses.

Centre Managers

Cal Williams and Ruth Rickman-Williams when on site will be available at The Cottage adjacent to the main building. When not on site they can be reached on 07870239077.

Arrivals

Please report to the office, which is situated in the Cottage, at the entrance to the site when you arrive. If there is no one in the office please phone the mobile (as above).

You will be shown to your site or building as necessary and any safety notices will be passed on at this time.

If you need any assistance moving equipment (particularly into the Grove) this will be done on arrival. Please request this service before you travel to the centre and let us know if you require us to tow your trailer or would like to borrow ours.

Please meet any parents who are dropping young people off in the car park. This restricts vehicle movement on site, reducing accidents and stops anyone in the office having to send every parent to your site or building.

Daniel's Grove has its own parking area, with space for approximately thirty cars if parked properly. There is space adjacent to the other sites for leader's cars, minibuses, etc. Those using the main building are welcome to drop equipment and food through any of the doors, but vehicles need to be moved into the main car park as quickly as possible.

The car park is large enough for coaches but please discuss this with us before arrival.

Departures

Please ensure departure by the allocated time as we may have groups moving into the building or onto your site immediately afterwards.

Buildings and sites must be left at least as clean and tidy as found. Please bring your own cleaning products and refuse / recycling bags. All rubbish and recycling must be out in the bins in the refuse area in the car park – recycling must be placed in clear bags not black or other opaque waste bags as the contractors will not collect it and it will then incur an additional charge.

Payment

Payment must be made before departure unless other arrangements have been made with the Centre Manager before arrival. It is useful to let us know numbers on site the day before paying so that we can prepare your invoice.

Payment can be made by BACS. We also accept cash and cheque payments.

If arrangements have been made to pay after the stay, please ensure that this is done within one month of departure.



On-Site Activities

Booking Activities

If you have not already done so, please book any on-site activities as soon as possible. This can be done by telephone or email and confirmation of what has been booked will be sent. Instructed activities are generally run by volunteers so we need to give them as much notice as possible. Please bear in mind that instructed activities are subject to availability. If there is more than one group on site, activities will be booked on a 'first come, first served' basis. Last minute cancellations or failure to turn up for an activity will incur the full cost of that activity.

All activity timings are for 1.5 hours to allow for programme management across the site. If you are booking a whole programme please talk to us as we are able to build flexible programmes to meet your programme needs.

A brief outline of our activities is included below (including recommended clothing). More information is available on our website.

Air Rifles (8-12 participants) on our covered outdoor range. Minimum age 8

Archery (8-12 participants) on our covered outdoor range. Long sleeved tops are recommended

Challenge Zone Situated in Daniel's Grove, the challenge activities are close to the stream, the area can get muddy and some activities may involve water, so expect to get grubby and wet. Wear old, comfortable clothes and shoes, or wellies (no open toed shoes) and please ensure they are free from mud / dirt before entering the site*. It can be useful to have a towel and change of clothes nearby. The Challenge Zone activities must be booked, and must be supervised by a sufficient ratio of staff in appropriate locations to monitor safety and conduct. Maximum group sizes will be specified according to the type and combination of activities booked. **Biosecurity to protect native / endangered species.*

Soft Archery This activity is aimed at younger users and is self supervised. We provide bows, arrows, targets and simple instructions, and you can set up in various locations.

Lawn Games These include Chess, Draughts and Noughts and Crosses.

Orienteering This is available at any time and takes place in Buckholt Wood. Groups need to set out the choice of route before it is used and collect it in afterwards so prior booking is important. Clothing suitable for the weather is required. The course can be muddy.

Pioneering We have a limited supply of ropes and poles as well as small 'practice' materials.

Quiz Walk The walk follows a route around the village of Cranham and takes up to two hours.

Sumo Wrestling Available to hire the activity can take place anywhere on site either inside or out.

Traverse Wall The wall is situated by the main camping area and is easily accessible. The wall is lit and so can be used for evening sessions. Open toed shoes must not be worn.

Team Building A range of team building activities are available including: spiders web, tower of Hanoi, 'river crossing', minefield, slack line let us know what you are looking for and we can arrange a team building package for you. Instructions are provided and can therefore be self led

Go Karts We have 3 Go karts that are available for use down the grassy slope



Off-Site activities

There are several activities available close by. These include:

- Indoor Climbing** at the Warehouse in Gloucester (GL1 1HY)
www.the-warehouse.co.uk/
Telephone: 01452 302351
- Water Sports** at Croft Farm Water Park, near Tewksbury (GL20 7EE)
www.croftfarmwaterpark.com
Telephone: 01684 772321
- Swimming** at GL1 in Gloucester (GL1 1DT)
www.aspiretrust.org.uk/gl1-leisure-centre
Telephone: 01452 396666
- at Sandford Parks Lido in Cheltenham (GL53 7PU)
www.sandfordparksido.org.uk/
Telephone: 01242 524430
- at Stratford Park Leisure Centre in Stroud (GL5 4AF)
www.everyoneactive.com
Telephone: 01453 766771
- Dry Ski Slope** at Gloucester Ski and Snowboard Centre (GL4 6EA)
www.gloucesterski.com
Telephone: 01452 501438
- Go Karting & Laser Tag** at JDR Karting in Gloucester (GL1 5SG)
www.jdrkarting.co.uk
Telephone: 01452 311211
- Mountain Biking** at Flyup - 417 Bike Park, Crickley Hill, Witcombe (GL3 4UF)
<https://417bikepark.co.uk/>
- High Ropes Course** at 270 Climbing Park, Benthams (GL3 4UD)
<https://www.270climbing.com/>
- Go Ape** at Lydney, Forest of Dean
www.goape.co.uk
Telephone: 0845 6439215
- Hiking** We can provide routes for walking locally.



Places to Visit

Cattle Country in Berkeley (GL13 9EW) www.cattlecountry.co.uk Telephone: 01453 810510

Clearwell Caves near Coleford (GL16 8JR)
www.clearwellcaves.com Telephone: 01594 832535

Corinium Museum in Cirencester (GL7 2BX)
www.coriniummuseum.cotswold.gov.uk Telephone: 01285 655611

Dr Jenner's House in Berkeley (GL13 9BN)
www.jennermuseum.com Telephone: 01453 810631

Gloucester Cathedral in Gloucester (GL1 2LX)
www.gloucestercathedral.org.uk Telephone: 01452 528095

Gloucester Rugby Club in Gloucester (GL1 3AX)
www.gloucesterrugby.co.uk Telephone: 0871 871 8781

Perrygrove Railway in Coleford (GL16 8QB)
www.gloucesterski.com Telephone: 01594 834991

Prinknash Bird Park near Cranham (GL4 8EX)
www.thebirdpark.co.uk Telephone: 01452 812727

Waterways Museum in Gloucester (GL1 2EH)
www.gloucesterwaterwaysmuseum.org.uk Telephone: 01452 318200

Wetlands & Wildlife Trust
in Slimbridge (GL2 7BT) www.wwt.org.uk/visit-us/slimbridge Telephone: 01453 891900

Other useful websites: www.cotswolds.com

www.cotswolds.info

www.royalforestofdean.info

Emergency Procedures

Main numbers – 999 Fire, Ambulance and Police

NHS medical help online – 111

Water (Severn Trent) 0800 783 444

Electricity (Western Power) – 0800 6783 105

Gas (Calor LPG) – 0345 609 6209

Minor Accident All groups need to provide their own qualified first aid personnel. If a member of your group has a minor accident, please deal with this yourselves. If the casualty is taken to hospital or to the doctors you will need to complete an accident form before departure. Accident forms are available from the office.

Major Accident If you need to take a casualty to the hospital, please do so. If you call an ambulance, please inform the Centre Manager at the earliest convenience. You will need to complete an accident form which is available from the office before departure.

Fire If you discover a fire please evacuate all members of your group to the main car park and inform the fire brigade immediately. Inform a member of staff at the earliest convenience.

Lost Members If you lose a member of your group while on site, please inform a member of staff. We will assist you in coordinating any search.

Power Loss – 0800 6783 105

Flooding - 999

Burst Pipe- Site contact Centre manager

Severe Weather – contact Centre manager



Nearest Hospitals

There are hospitals in:

Gloucester Gloucestershire Royal Hospital is six and a half miles from Cranham (Post Code – GL1 3NN) and has an A & E Department open 24 hours

Stroud Stroud General Hospital is eight miles from Cranham (Post Code – GL5 2HY) and has a Minor Injuries Department

Cheltenham Cheltenham General Hospital is eight and a half miles from Cranham (Post Code – GL53 7AN) and has an A & E Department open 7 days a week 8am – 8pm

Cirencester Cirencester Hospital is thirteen miles from Cranham (Post Code – GL7 1UY) and has a Minor Injuries Department

Nearest Doctors

The nearest doctors is at Painswick Surgery, Hoyland House, Gyde Road, Painswick, GL6 6RD (Telephone – 01452 812545)

The easiest way to get there is to drive up to the A46 and turn left. Follow the A46 into Painswick and turn right at the traffic lights. Gyde Road is the third road on the right, and the surgery is at the far end of the road.

Nearest petrol station GL3 4PL– Cross Hands roundabout, Drive up to A46 and turn right, follow the road to the bottom of the hill. The garage is on the right-hand side just before the roundabout

Nearest Shops – Tesco Express, 254 Painswick Rd GL4 4BS, Tesco Extra Gloucester Business Park GL3 4AA, Morrisons Heron Rd, Abbeydale GL4 4FF



Safeguarding

The Safeguarding Policy at Cranham is that of the Scout Association. Young People First

Copies are available by contacting us or by telephoning the Scout Association direct on 0345 300 1818.

In the interests of the young people using our facilities, all visiting groups should follow our Safeguarding policy or provide us a copy of their organizational safeguarding policy:

It is our policy to safeguard the welfare of all young people by protecting them from physical, sexual and emotional harm.

Accordingly, Cranham Scout Centre is committed to:

- Respecting the rights, wishes and feelings of the young people with whom it is working.
- Taking all reasonably practicable steps to protect them from physical, sexual and emotional abuse.
- Promoting the welfare of young people and their protection within a relationship of trust.

Risk Assessments

We encourage all groups to perform their own risk assessments for the camping area or building that they are using and any activities that they are planning to do. If you require assistance in producing risk assessments, please do not hesitate to contact us. Activity risk assessments are available on our website, which you can use as part of your own risk assessments.



Directions

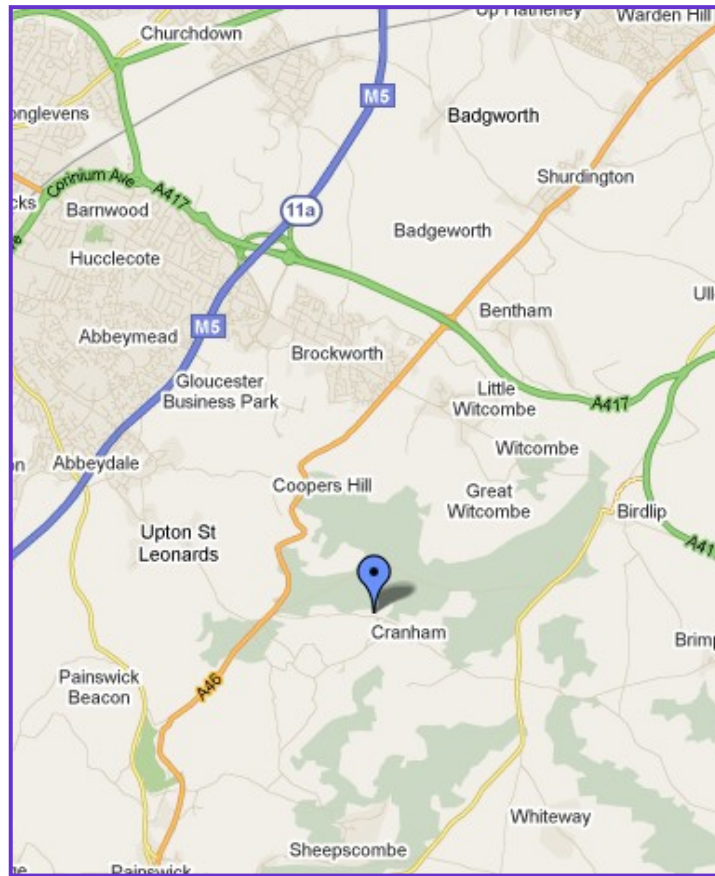

The roads close to Cranham are very narrow. If you are travelling by coach, please let us know when booking.

From the M5

- Leave the M5 at Junction 11a and follow the A417 towards Cirencester.
- Leave the A417 at the next junction (sign posted Brockworth and Shurdington) and take the third exit at the roundabout along the A46 towards Stroud.
- Follow the A46 for 3.2 miles until you see a sign for Cranham. Turn left, and after 50 yards turn right (sign posted Scout HQ).
- Follow this road to the bottom of the hill. Cranham Scout Centre is on the left-hand side.

From the M4

- Leave the M4 at Junction 15 and take the third exit at the roundabout along the A419 towards Cirencester. Continue along this road (changes to the A417 and 14.5 miles) until it changes from dual carriageway to single carriageway.
- Take the second exit and continue along the A417 for 1.5 miles and turn left along the B4070 (sign posted Birdlip)
- Follow through Birdlip. After the pub on the right, turn left along the B4070.
- After 1.6 miles turn right (sign posted Cranham) and follow to the bottom of the hill. Cranham Scout Centre is on the right hand side.



Site Plan

Cranham Scout Centre

MAIN SITE



Legend

Activities

- Air Rifle Shooting
- Archery
- Camp Fire Circle
- Play Area
- Team Building
- Traverse Wall

Facilities

- Chapel
- Bunk Cabin
- Kitchen Cabin
- Electrical Pick-up Point
- Main Accommodation & Dormitories
- Recycling & Waste
- Cooking/ Dining Shelter
- Showers
- Gents
- Ladies
- Accessible
- Washing Up
- Water point
- Stile
- Office
- Staff Accommodation

Site Use

- Site Boundary
- Gate
- Stream or Ditch
- Building
- Marquee
- Propane Tank
- Public Road
- Access Road
- Carpark
- Activity Area
- Out of Bounds
- Camping Areas
- Hedge
- Wooded or other grassland



**CRANHAM
SCOUT CENTRE**

Cranham Scout Centre



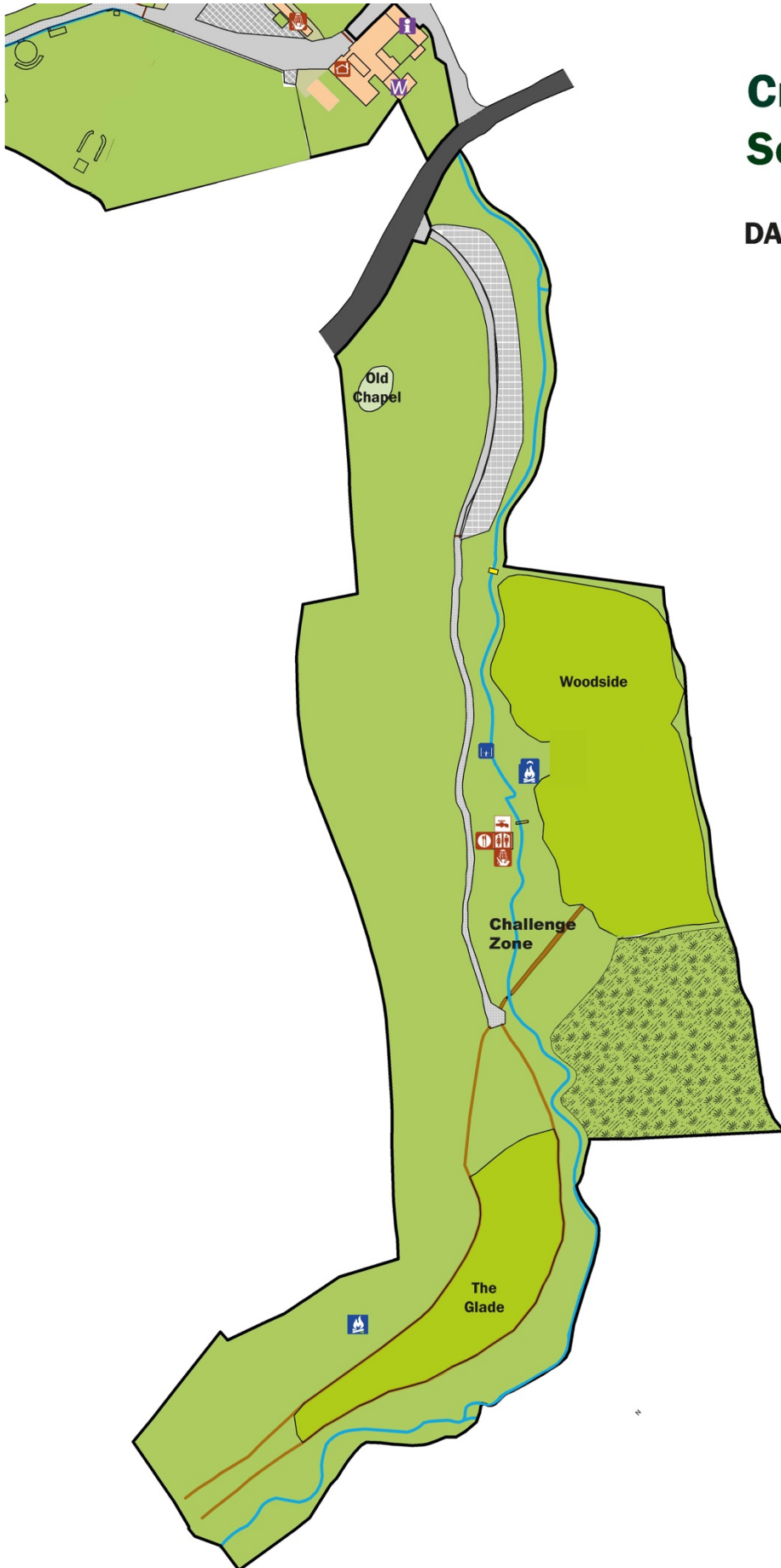

DANIELS' GROVE













Legend

 Camp Fire Circle

Facilities

-  Showers
-  Gents
-  Ladies
-  Washing Up
-  Water point

Site Use

-  Site Boundary
-  Gate
-  Paths
-  Stream or Ditch
-  Building
-  Public Road
-  Access Road
-  Carpark
-  Pedestrian Bridge
-  Camping Areas
-  Wooded or other grassland





Cranham Scout Centre Campsites, Outdoor Facilities & Activity Areas

We are proud of Cranham Scout Centre, please help us to look after and care for the facilities we are privileged to use. Please read the following information points, which will assist in operating a safe and enjoyable experience.

On arrival - Please inform us of your arrival. Only leaders' vehicles are permitted to use the parking adjacent to each campsite. All 'dropping off' and collections must be from the main car park.

For campers using The Grove – by prior arrangement we will take your kit down to your site for you.

Vehicles – No vehicles at any time, are permitted on any Campsite or beyond the gateway in The Grove

Prohibited areas Any fenced/gated compound
Workshop and covered store
the Indoor centre, tents and structures, unless they form part of your booking

Noise - Respect the privacy of village residents and do not shout or chase about the Village at any time.

Quiet in camp is expected between the hours of 11pm and 7am. The playing of music, radios etc should be such that it cannot be heard beyond your camping field and does not create a nuisance

Fires – No ground fires are permitted, apart from in designated fire circles, or in altar fires. No axes or saws are permitted in the adjacent woodland. Collect only fallen wood. Use of the fire circle in the evenings for residential groups is by mutual negotiation between groups.

Water – Please do not waste water – the water on site is metered and is intended for drinking, cooking and hygiene purposes only. There are standpipes located at convenient locations around the site. Please ensure you don't block up the drainage ditches that run down the site.

Waste – All waste must be sorted and recycled, using the bins situated in the main car park. The mixed recycling caters for food and drink cans, plastic bottles and cartons, aerosols, gas cannisters, paper and cardboard. Glass recycling is for clean jars and bottles. General waste is for anything else. All ash from fires to be left in altar fires, to ensure safe disposal. **Wastewater** – Please dispose of into a sink or drain.

Toilet blocks – It is the responsibility of leaders to ensure that the toilet blocks remain clean, including routine checks to ensure toilets have been flushed. Toilet blocks are not play areas and anyone found abusing this will be asked to leave the campsite. The washing up of eating and cooking equipment in the toilet sinks is strictly prohibited. If there are any issues with the toilets, please let us know.

Washing Up Shelter – There is a washing up shelter situated by the Bottom Field. This is available for all campers, there are fridges and freezers inside. There is a 15-litre water heater for washing up. This takes 20 minutes to reheat if all the water is used.

Boundaries – Please use only gates and/or stiles where access is permitted. Do not climb over walls and fences. All land adjoining the Campsite and the Grove area is not owned by Gloucestershire Scouts. Please use the Countryside code and respect this area of outstanding natural beauty.

Activity areas – Do not use the activity areas without responsible supervision and booking where required.

The Stream – Please do not enter the stream without prior permission and complying with the bio security arrangements. Dam building is not permitted in the stream. The Grove has several leaky dams installed. Please do not alter these, if you'd like more information on these please let us know.

Dogs – In the interests of safety, no dogs are allowed on site except guide dogs.

WiFi – Is available in the main building and at various points around the main site.

On departure – all campsites, outdoor facilities and activity areas must be clean with all litter removed and all left over wood returned to the wood pile, adjacent to the campfire circle. Please leave the site as you would expect to find and ready for the next group

Thank you for working with us to ensure happy safe camping at Cranham, any questions please ask the Centre Manager or Duty Warden. We hope you enjoy your stay at **Cranham** and return often.

Cal & Ruth Williams, Centre Managers



Buildings

The Main Centre

Floor Plan

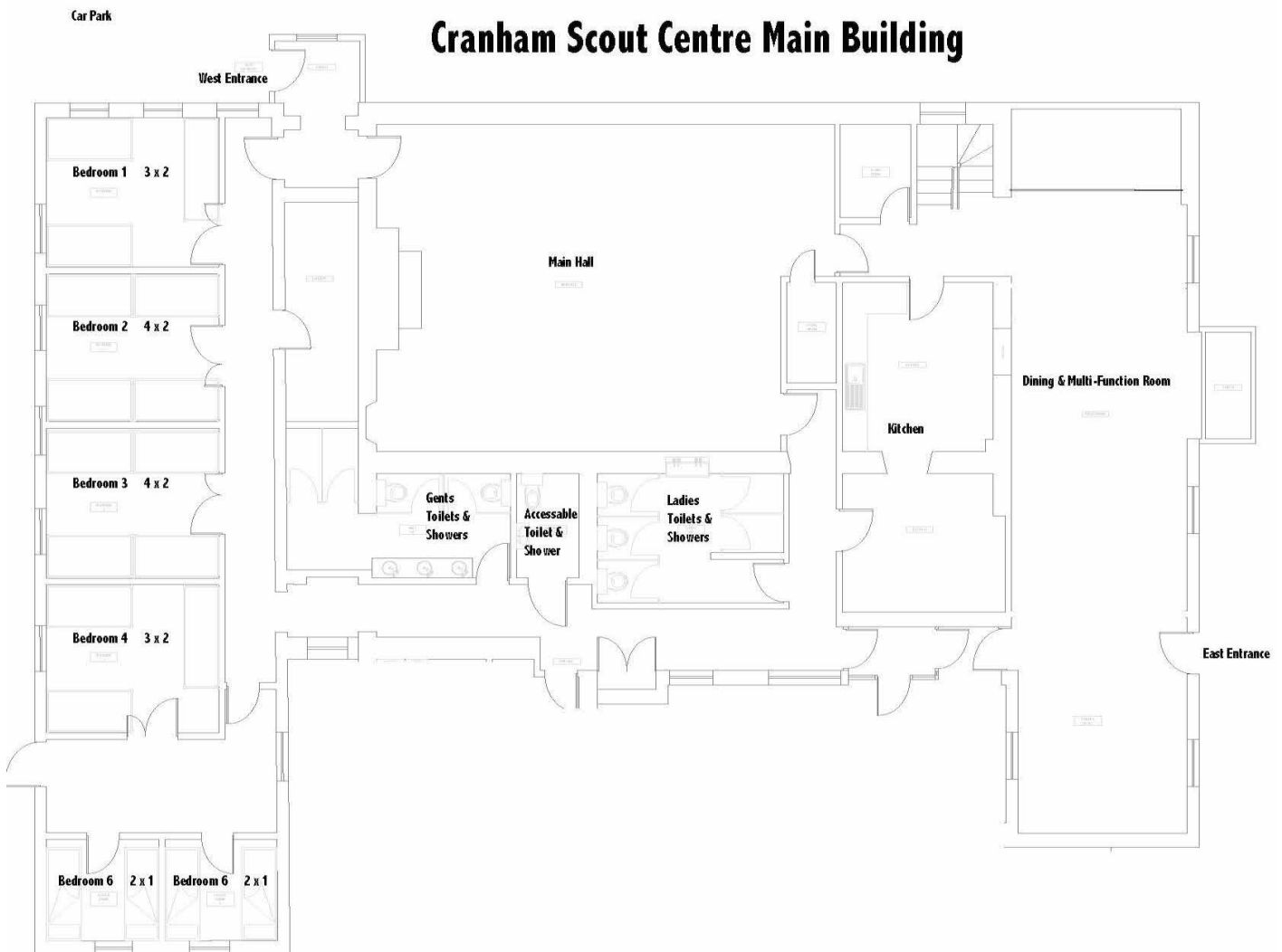

Please note:

There is *no employed cleaner* for the centre, please leave the building as you find it. If the building is left unclean a cleaning charge of £25 per hour will be levied

A vacuum and mops and buckets are available please bring your own cleaning materials

Please ensure all rubbish and recycling is taken out to the refuse area located in the car park

There is a fire alarm in the main building. This will be tested with you when you arrive and you will be shown how to silence it if you know it is not an emergency. If the fire alarm sounds, the building must be evacuated.

The **projector** and **sound system** situated in the main hall can be used by residents of the main building by prior arrangement.

You will be provided with a key for this building when you arrive. Please ensure you return the key before departure, by putting it through the letterbox on the front of the cottage



Checklist before departure

Check all heaters in the bedrooms are turned off in down to 2 (or off in summer) and the dining room to 13 degrees

Check all taps are switched off

Check all bins are emptied and put in the appropriate refuse bins located in the car park (general waste black bags, recycling clear plastic bags)

Check all main areas including the corridors are vacuumed

Check kitchen, toilets and showers are all mopped

Check washbasins and toilets are wiped clean

Check all lights are switched off

Check fridges are emptied and wiped clean

Check no food has been left in the oven and that the oven is wiped clean

Check that sinks and surfaces have been wiped down

Check the fire doors (dining room and end of bunk rooms) are securely fastened

Check all windows are latched, doors are locked, and gates closed / locked as required. Keys should be returned to the appropriate keysafe or to the centre office (through the cottage letterbox).

Thank you!



Main Building – Kitchen Inventory

Appliances

Microwave, Toaster, Water boiler

Catering Equipment

Oven with six ring hob

Fridge and Freezer

Tea pots (2)

Grater (3)

Jugs (4 glass) (7 plastic) (2 stainless steel) (2 insulated)

Colanders (3)

Deep oven trays (6) Shallow oven trays (8) Frying pans (2)

Pans – large (4) Pans – small (5) Plastic bowls (2 large) (3 small)

Baking sheets (5)

Trays (8)

Can opener (1 wall) (2 hand held)

Fish slice (2)

Large spoons (3) slotted (3)

Masher (2)

Palette knife (1)

Peelers (3)

Scissors (5)

Sharp knives (13)

Tongs (3)

Whisk (1)

Wooden spoons (5)

Pizza wheel (2)

Sieve (1)

Bottle opener (1)

Knife sharpener (2)

Rolling pins (2)

Scoop (1)

Cutlery & Crockery

Plates (34)

Bowls (32)

Mugs (28)

Beakers (30)

Knives (40)

Forks (32)

Spoons (48)

Tea spoons (8)



The Bunk Cabin

Floor Plan

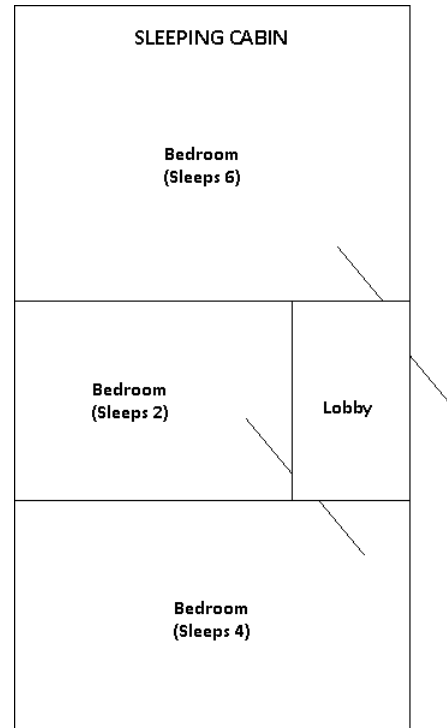
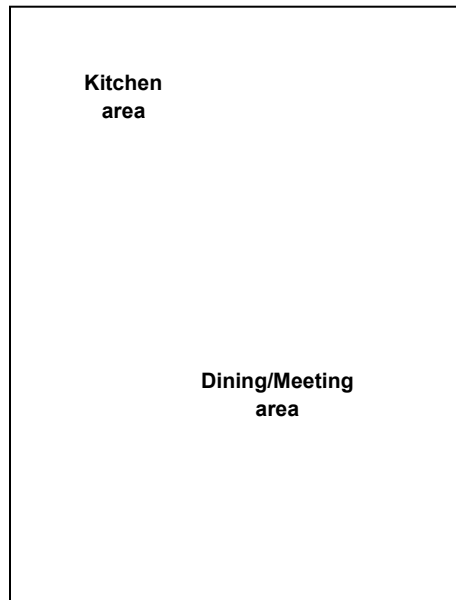

Please note:

- These plans are not to scale

You will be provided with the key code for these buildings before you arrive. Please ensure doors are locked and you return the keys to the key box before departure.

Check list before departure

Please ensure the cabins are left clean and tidy.

Floors mopped and vacuumed

Windows are closed

Fridge empty and clean

Rubbish and recycling (in clear bags) put in the large bins in the bin area (car park)

Heaters are all down to 2. The heater in the entrance lobby is only a frost precaution so please do not attempt to adjust or switch off.



Day Cabin – Kitchen Inventory

<u>Item</u>	<u>Quantity</u>
Metal forks	13
Metal spoons	8
Bigger metal spoons	9
Metal knives	26
Tea spoons	4
Plastic spoons	1
Large thick knives	3
Medium long knives	3
Spatula	3
Slotted spoon	3
Large spoon	1
Wooden spoon	2
Peeler	2
Can opener	1
Scissors	1
Tongs	2
Baking tray	3
Grill tray	1
Oven tray	2
Small cooking pot	1
Large cooking pot	3
Small cooking pot with drain	2

Sieve	1
Chopping boards	5
Frying pan	2
Mixing bowl	2
Jugs	4
Pint glasses	12
Regular glass	3
Small glass	2
Plastic glass	24
Mugs	14
Bowls	14
Cheese grater	1
Plates	18
Tea cups	13
Tall glass	1
Masher	1
Ladle	3
Whisk	2
Fridge	1
Oven	1
Microwave	1
Kettle	1
Freezer	1
Toaster	1